

All finishes to be robust.
Corners should be protected
and 'softened'.

Interview room located
adjacent to the lobby with
soft furnishings and good IT
for transfer of custody

Site entry should shield blue
light from patients and local
residents.

Admission can be a disturbing
experience - the facility should
provide a positive distraction.

Bedroom with en-suite is NOT
a seclusion room but should
be designed to be robust
and high risk (either, no door
to en-suite or use lock-back
door).

Co-located the facility with an
inpatient unit, offering staff
support and access to physical
treatment.

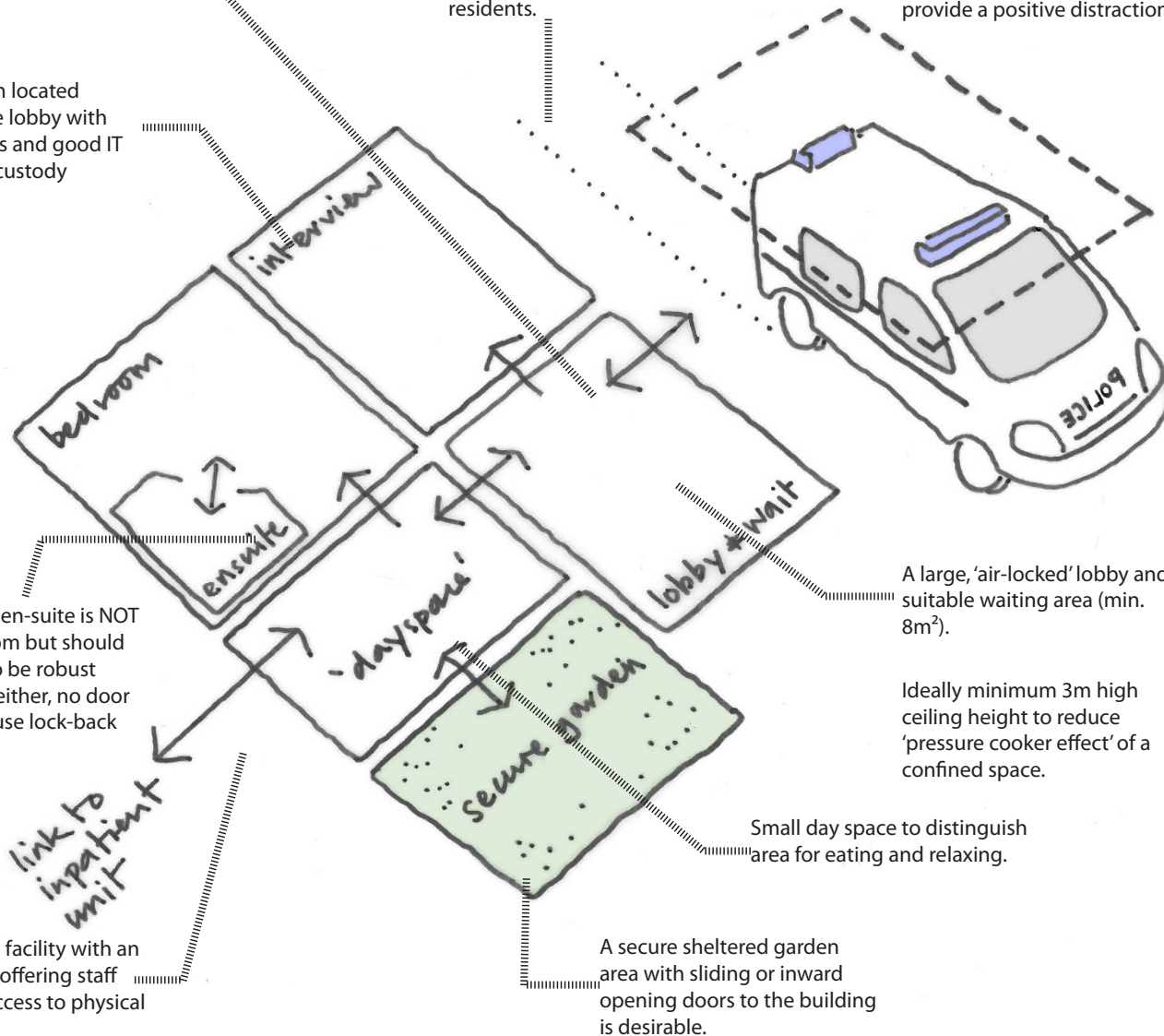

A large, 'air-locked' lobby and
suitable waiting area (min.
8m²).

Ideally minimum 3m high
ceiling height to reduce
'pressure cooker effect' of a
confined space.

Small day space to distinguish
area for eating and relaxing.

A secure sheltered garden
area with sliding or inward
opening doors to the building
is desirable.

10

STEPS TO BEST PRACTICE

Section 136

An order which allows a police officer to take a person whom they consider to be mentally disordered to a "place of safety".